

PIONEERING TECHNOLOGY DAY

PROGRAM

\$ = Items for sale

(Support our local Artisans)



= Hands-on Activity



= Demonstration

Area A – Science Center

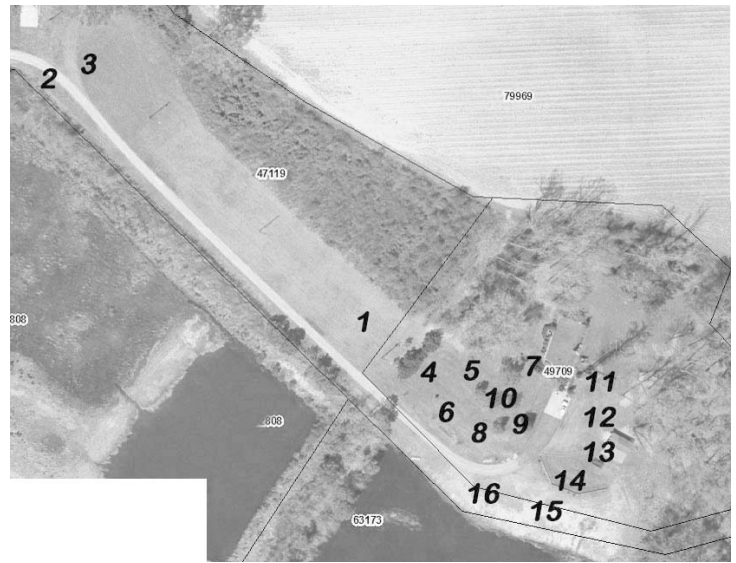

1	<i>A Time for Science (ATFS)</i> – Registration and Sign-in	\$		
2	<i>ATFS</i> – Manual Water Pump			
3	<i>ATFS</i> – Four-Seasons Organic Garden			
4	Nooherooka Natural Beef	\$		
5	Locavore Market	\$		
6	Love A Sea Turtle – Beverages and Baked Goods	\$		
7	Music Stage and ATFS Center			
8	Jennifer Christensen – Pine Needle Baskets – and 4-H	\$		
9	Bill McClung – Pitt Pirates Robotics			
10	<i>ATFS</i> – Information, Shirts, Souvenirs Also Bum’s BBQ Sandwiches between 11:00 and 2:00	\$		
11	Jim Cooper – Native American Flutes & Drums	\$		
12	<i>ATFS</i> – Space Shuttle Tire and NASA’s Send Your Name to Mars			
13	Love2Forge, Matthew Bray – Knife Forging	\$		
14	<i>A Time for Science</i> – Tours of Bray Hollow Conservancy (11:00, 1:00, 3:00)	\$		
15	Sam Christensen – Coal Burned Bowls			
16	<i>A Time for Science</i> – Make a Sundial with Emma Tucker			

SPECIAL EVENT

Music Through the Day *Beginning at 11:00*

The Zen Revelators will lead off followed by Chance Bair & Friend around 2:00. There will be periodic performances of Native American flute and drum music.

Performances at Area A #7

SPECIAL EVENT

Contributions of John Lawson *1:00*

At the ATFS Center, Dr. Vince Bellis, ECU Botany (ret), will discuss the contributions of John Lawson’s herbarium collection to the history of the area and will demonstrate how to prepare such samples.

No Charge but Limited space.

Reservations at the ATFS Information Area A #10

► Special thanks to all of our D.H. Conley High School student volunteers ◀

SPECIAL EVENT

Canoe The Creek *11:00 and 2:00*

Melissa Myers & Phil Patrick will guide you on a one hour paddle of Little Contentnea Creek as you learn about the Native Americans who lived along its banks

Charge is \$5/Person

Limited to around 15 participants per trip

Reserve your place at Area C #26

Area B – Creek Side

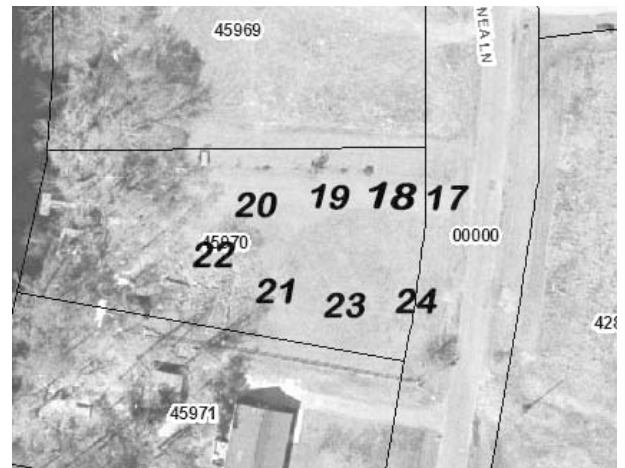

17	Nancy Winn – Papermaking	\$		
18	Dragonfly Beads, Nan Wynne – Paper Bead Making	\$		
19	Joanne Lang – Weaving			
20	Mary Miller – Quilting	\$		
21	Diane Gregg – Knitting			
22	ATFS – “Old Timey” Toys	\$		
23	Old Carolina Soap – Soap Making	\$		
24	Andy McLawhorn – Pottery	\$		

SPECIAL EVENT

Astrohack Balloon Launch

Between 12:00 and 1:00









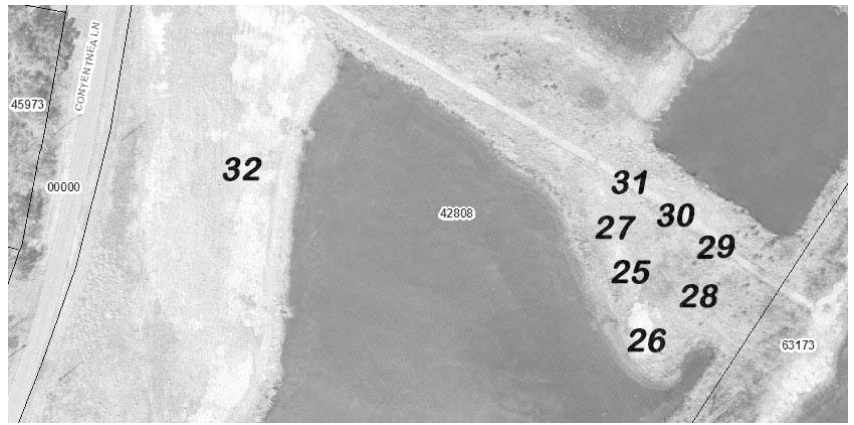



Watch Systems Architect Ryan Butcher and Pilot Joe Downing set up and launch their balloon borne cameras to the edge of space. Hear about their previous launches

Area C – Pond Site

and see their incredible pictures.

Takes place at Area C #32



25	Ruth Larson – Kudzu Basket Making	\$		
26	Tom Fink – Canoeing Demonstration Melissa and Phil will sign-up participants for the two Canoe Paddle trips on Little Contentnea Creek	\$		
27	Paul Gianino – Master Carpentry, Woodcraft and Furniture	\$		
28	Brightleaf Amateur Radio Club (W4AMC)			
29	Stephen Brand – Humanure Sanitation System			
30	Emerald Energy Solutions, Jon Weaver – Renewable Energy	\$		
31	Pitt Community College, Charles Goodman – Telescope Making			
32	Astrohack, Ryan Butcher – Near Space Balloon Launch			

► Thanks to all of our *A Time for Science* volunteers ◀